

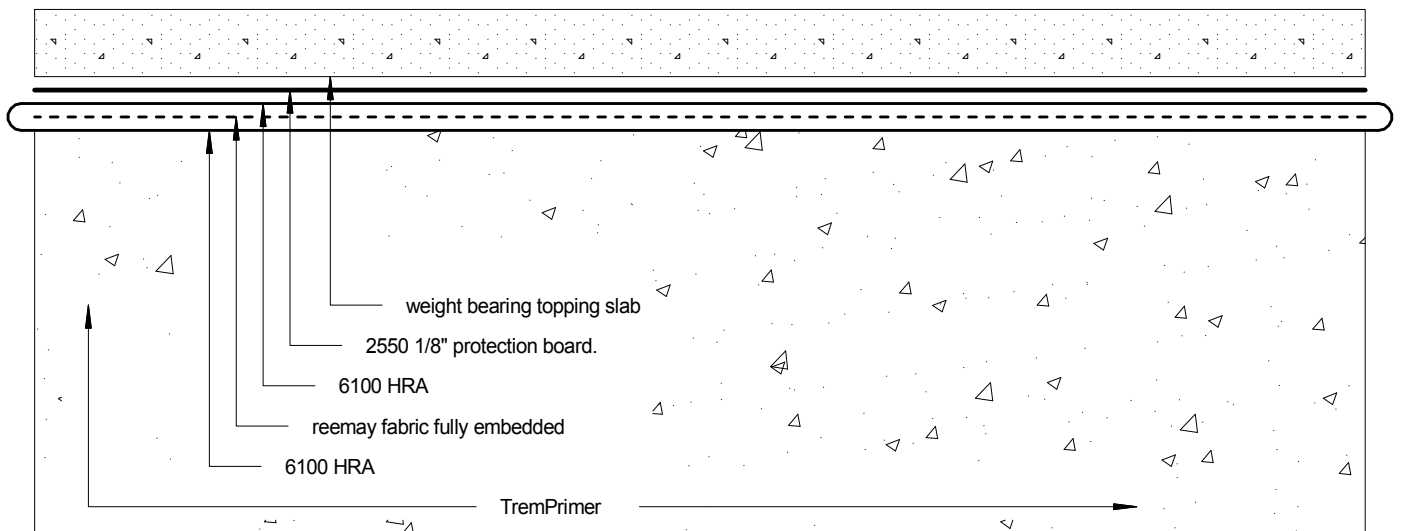

TP-6100 HRA Spilt Slab Installation

Shown: Fully reinforced 6100 HRA installed to structural concrete c/w 2550 protection board under weight bearing topping slab.

detail>> D-1215-182A



Tremco Canada
6178 Netherhart Rd.
Mississauga, On.
L5T 1B7
Ph: 905-564-6100
Fax: 905-564-6110

Tremco Inc.
www.tremcosealants.com

Tremco Inc.
3735 Green Rd,
Beachwood, OH. USA
44122
Ph: 216-292-5000
Fax: 216-292-5036

<u>Date:</u> Jun-25-2010		<u>Drawing No.</u> D-1215-182A
<u>Drawn by:</u> G.M.	<u>Approved:</u> <>	<u>Scale:</u>
<u>Project:</u>		