

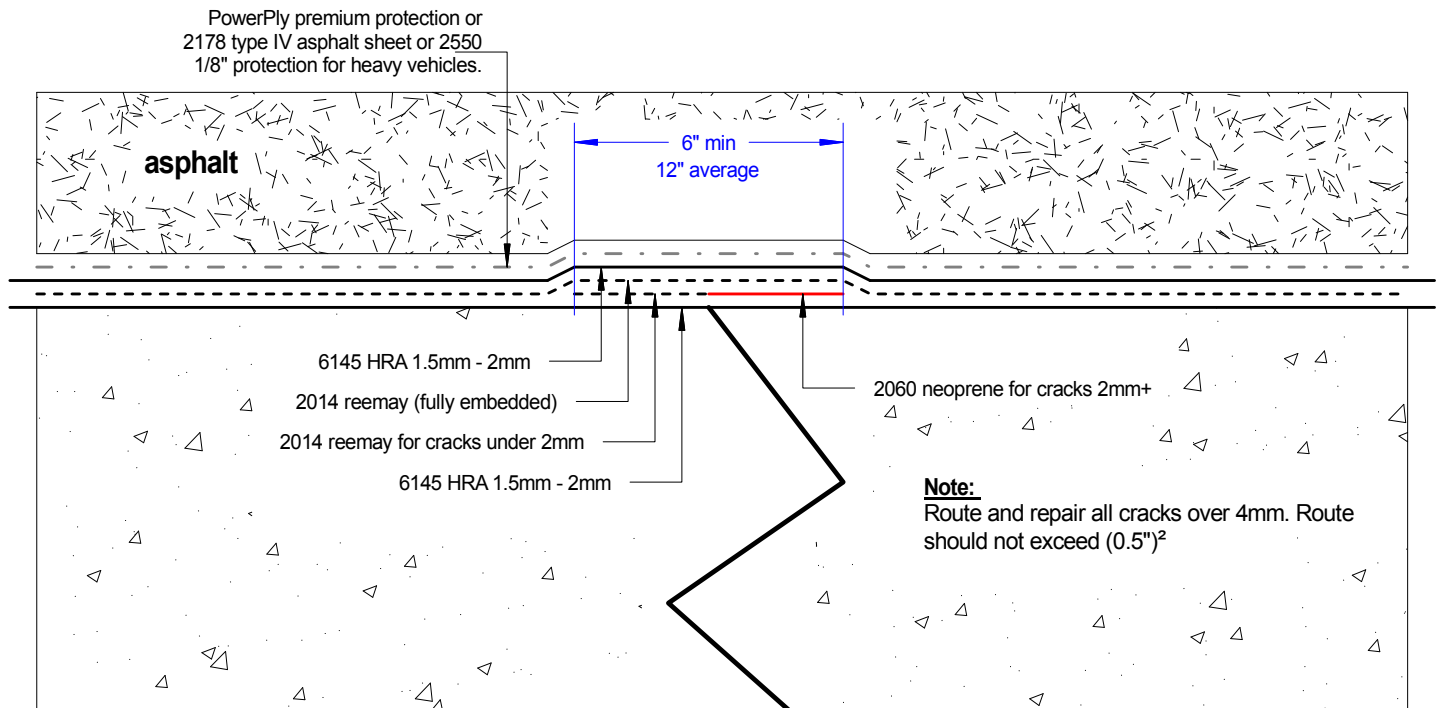

6145 Permaphalt HRA Membrane System  
shown: crack reinforcement to concrete substrate

Detail>> D-1063-2A



Tremco Canada  
6178 Netherhart Rd.  
Mississauga, On.  
L5T 1B7  
Ph: 905-564-6100  
Fax: 905-564-6110

**Tremco Inc.**  
[www.tremcosealants.com](http://www.tremcosealants.com)

Tremco Inc.  
3735 Green Rd,  
Cleveland, OH. USA  
44122  
Ph: 216-292-5000  
Fax: 216-292-5036

<u>Date:</u> July-17-2008		<u>Drawing No.</u> D-1063-2A
<u>Drawn by:</u> G.M.	<u>Approved:</u> <>	<u>Scale:</u>
<u>Project:</u>		



## 6145 Permaphalt HRA Membrane System

Shown: 6145 HRA installation to drain c/w  
2060 neoprene 2014 reemay

Detail>> D-1064-6A

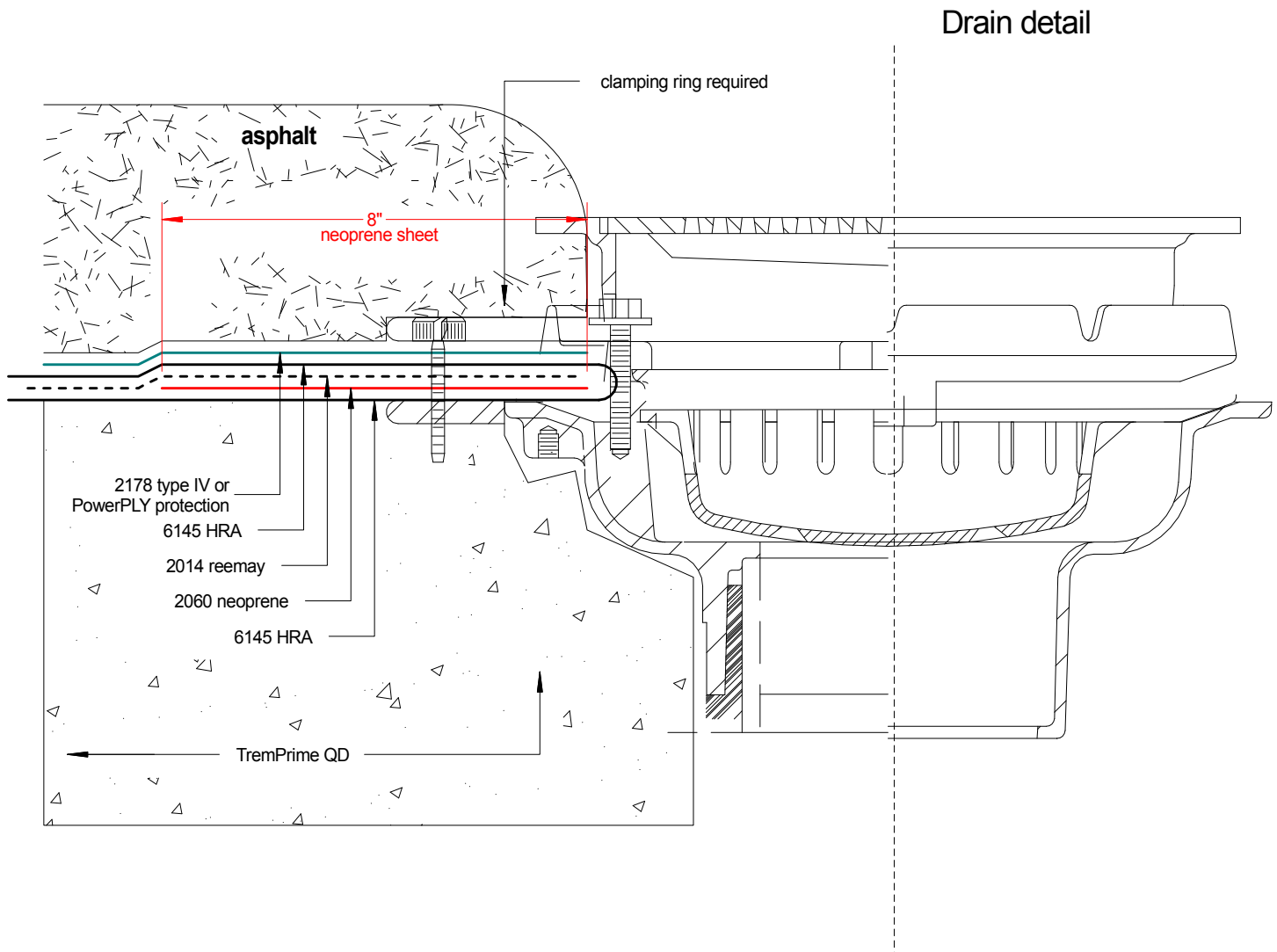

Tremco Canada  
6178 Netherhart Rd.  
Mississauga, On.  
L5T 1B7  
Ph: 905-564-6100  
Fax: 905-564-6110

**Tremco Inc.**  
[www.tremcosealants.com](http://www.tremcosealants.com)

Tremco Inc.  
3735 Green Rd,  
Cleveland, OH. USA  
44122  
Ph: 216-292-5000  
Fax: 216-292-5036

<u>Date:</u> Jul-17-2008		<u>Drawing No.</u> D-1064-6A
<u>Drawn by:</u> G.M.	<u>Approved:</u> <>	<u>Scale:</u>
<u>Project:</u>		



## TP-6145 Permaphalt System

Shown: downturn / upturn  
Detail>> D-614-7A

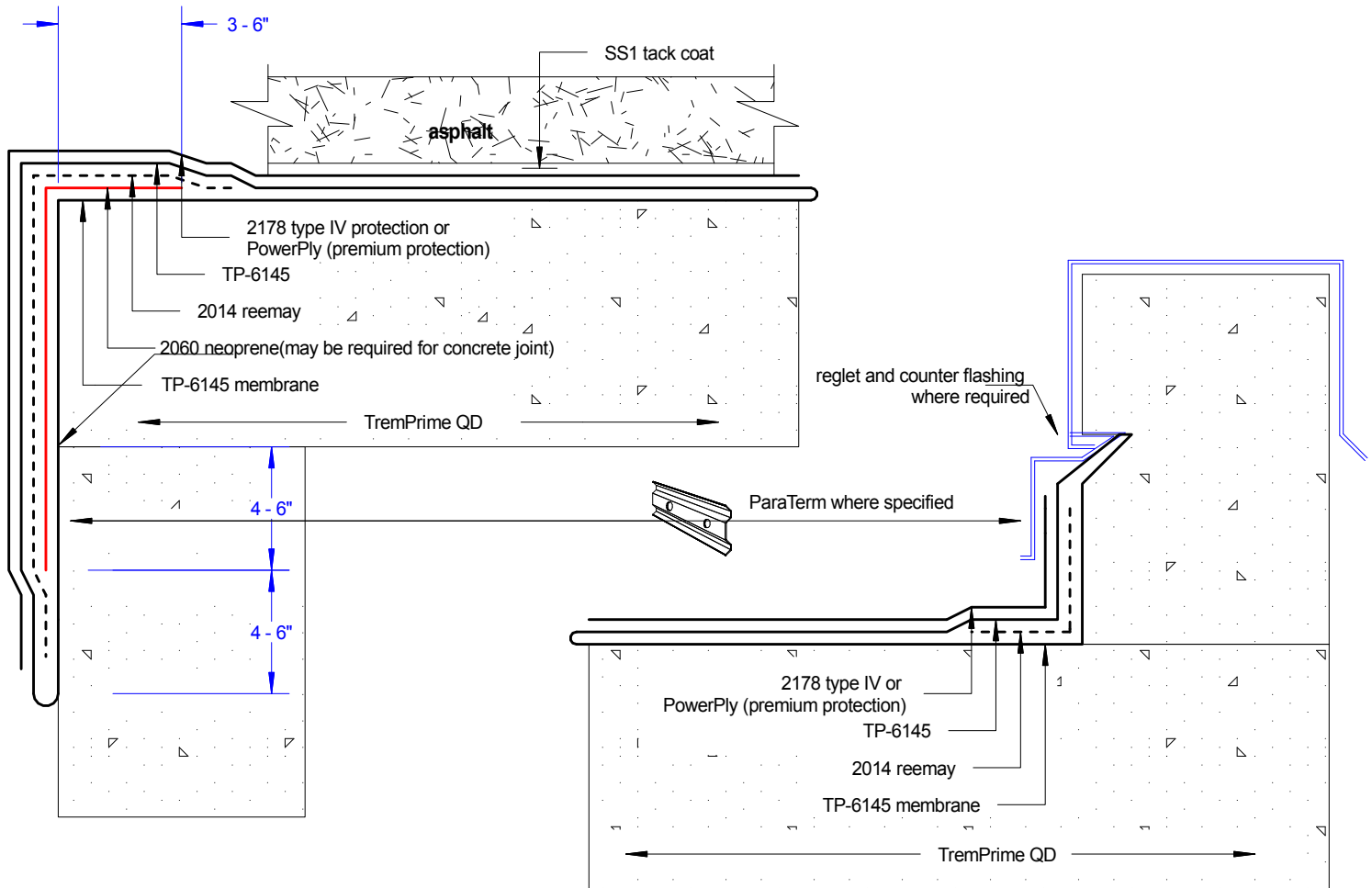

Tremco Canada  
6178 Netherhart Rd.  
Mississauga, On.  
L5T 1B7  
Ph: 905-564-6100  
Fax: 905-564-6110

**Tremco Inc.**  
www.tremcosealants.com

Tremco Inc.  
3735 Green Rd,  
Cleveland, OH. USA  
44122  
Ph: 216-292-5000  
Fax: 216-292-5036

Date:  
Feb-5-2008

Drawing No.  
D-614-7A

Drawn by: G.M.  
Approved: <>

Scale:

Project:



## 6145 Permaphalt III Fully Reinforced Traffic Membrane System

Shown: 6145 HRA membrane upturn c/w 2190 UV cap sheet upturn.  
This detail would be used where UV exposure may be imminent.

detail>> D-1062-1A

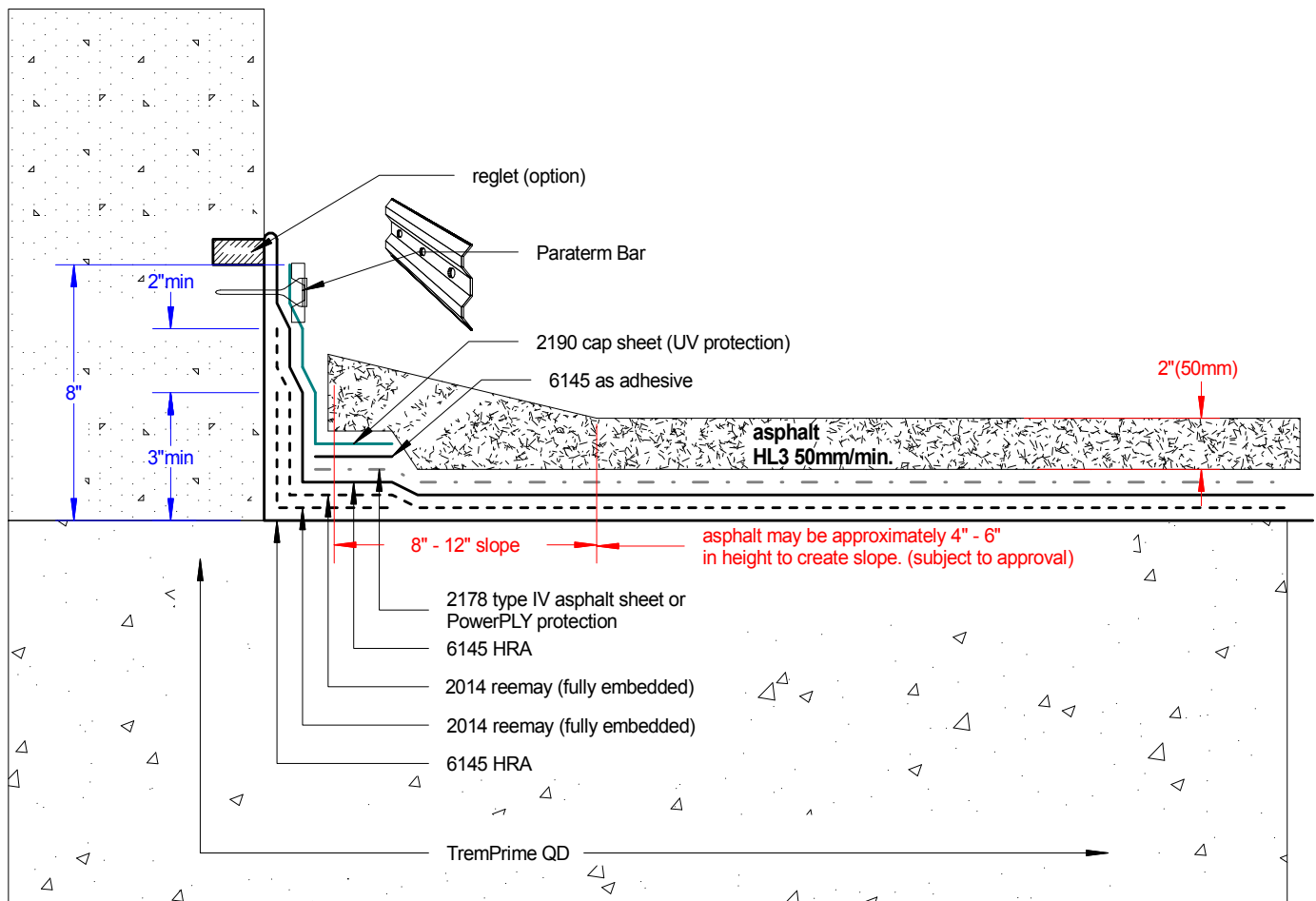

Tremco Canada  
6178 Netherhart Rd.  
Mississauga, On.  
L5T 1B7  
Ph: 905-564-6100  
Fax: 905-564-6110

**Tremco Inc.**  
[www.tremcosealants.com](http://www.tremcosealants.com)

Tremco Inc.  
3735 Green Rd,  
Cleveland, OH. USA  
44122  
Ph: 216-292-5000  
Fax: 216-292-5036

<u>Date:</u> Jul-17-2008		<u>Drawing No.</u> D-1062-1A
<u>Drawn by:</u> G.M.	<u>Approved:</u> <>	<u>Scale:</u>
<u>Project:</u>		



## 6145 Permaphalt System thin set traffic membrane.

Upturn Detail> D-626-2A (rev: Feb-5-2008)

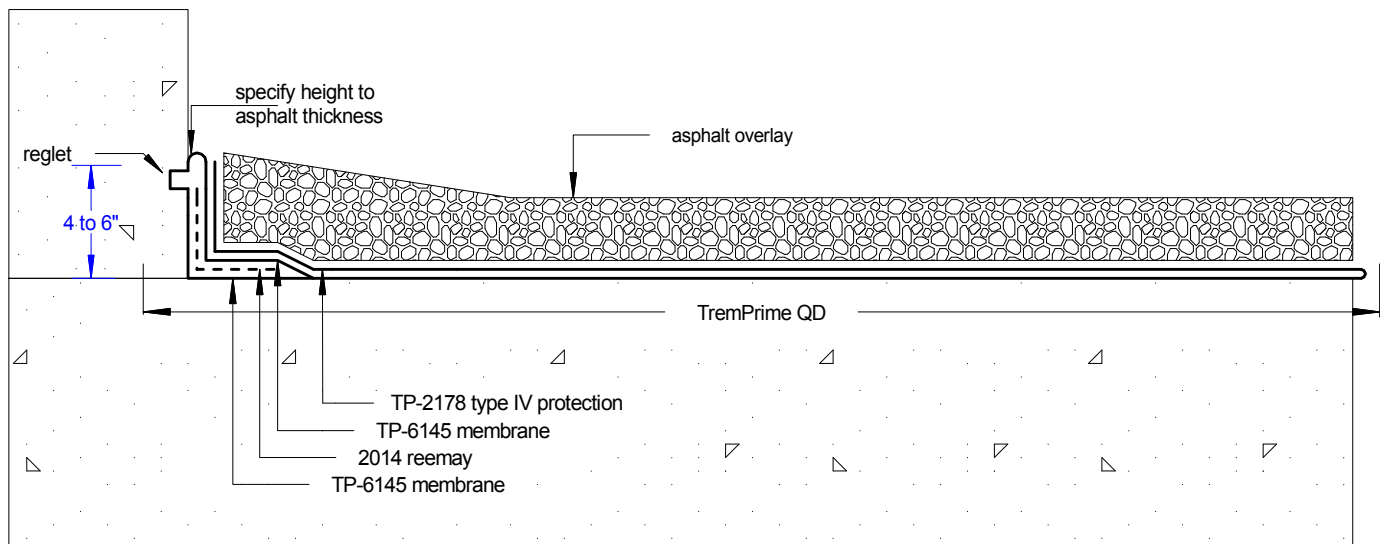

Tremco Canada  
6178 Netherhart Rd.  
Mississauga, On.  
L5T 1B7  
Ph: 905-564-6100  
Fax: 905-564-6110

**Tremco Inc.**  
[www.tremcosealants.com](http://www.tremcosealants.com)

Tremco Inc.  
3735 Green Rd,  
Cleveland, OH. USA  
44122  
Ph: 216-292-5000  
Fax: 216-292-5036

Date:  
Jan-22-2006

Drawing No.  
D-626-2A

Drawn by:  
G.M.

Approved:  
<>

Scale:

Project:



Permaphalt III-R 6145 HRA Upturn "options". Application to concrete parking or ramp.

detail>> D-943-5A-R1

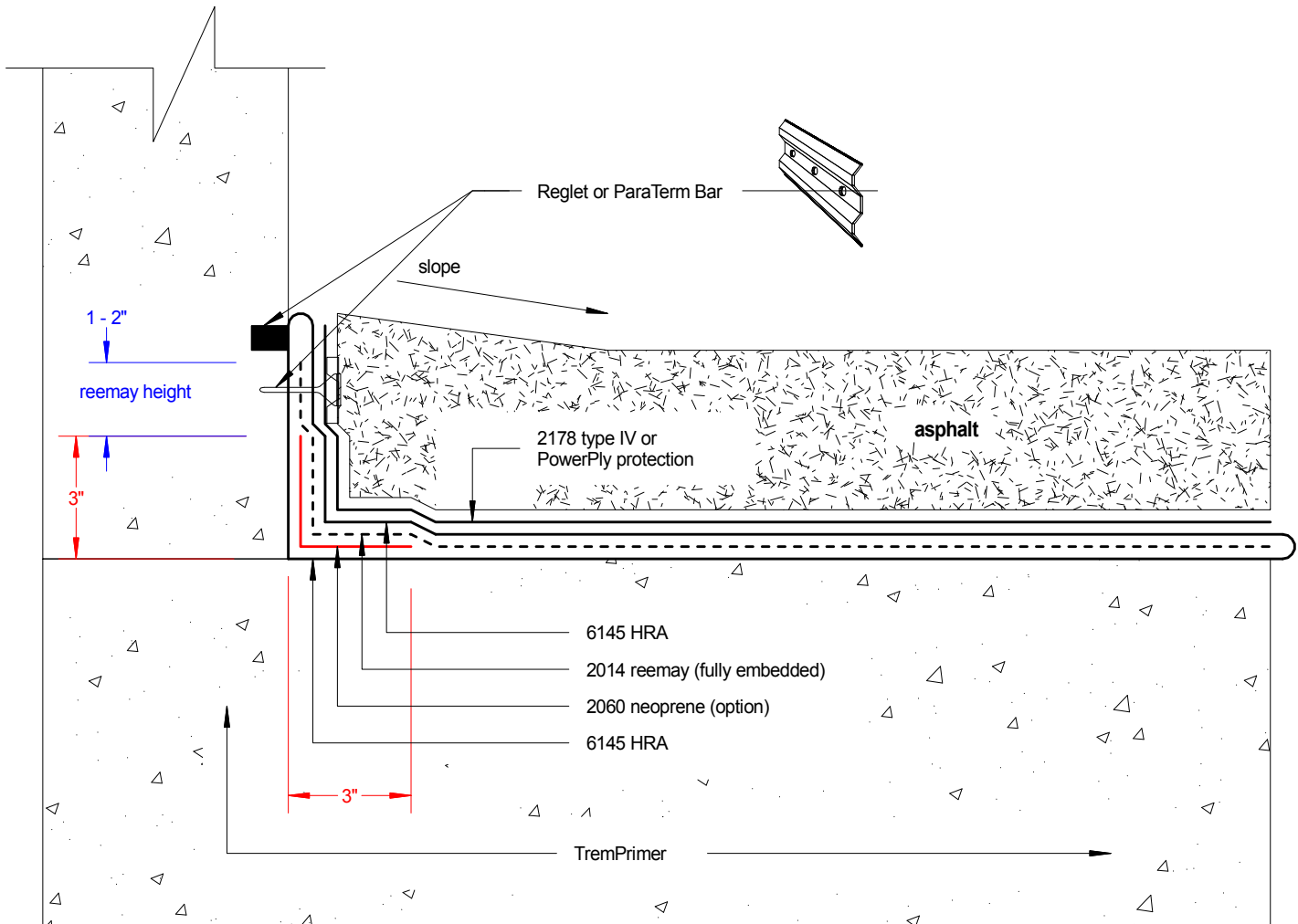

Tremco Canada  
6178 Netherhart Rd.  
Mississauga, On.  
L5T 1B7  
Ph: 905-564-6100  
Fax: 905-564-6110

**Tremco Inc.**  
www.tremcosealants.com

Tremco Inc.  
3735 Green Rd,  
Cleveland, OH. USA  
44122  
Ph: 216-292-5000  
Fax: 216-292-5036

<u>Date:</u> Apr-12-2009		<u>Drawing No.</u> D-943-5A-R1
<u>Drawn by:</u> G.M.	<u>Approved:</u> <>	<u>Scale:</u>
<u>Project:</u> typical		



Outside corner detail  
Shown: Neoprene elastomeric sheet cut pattern

D-1486-4A

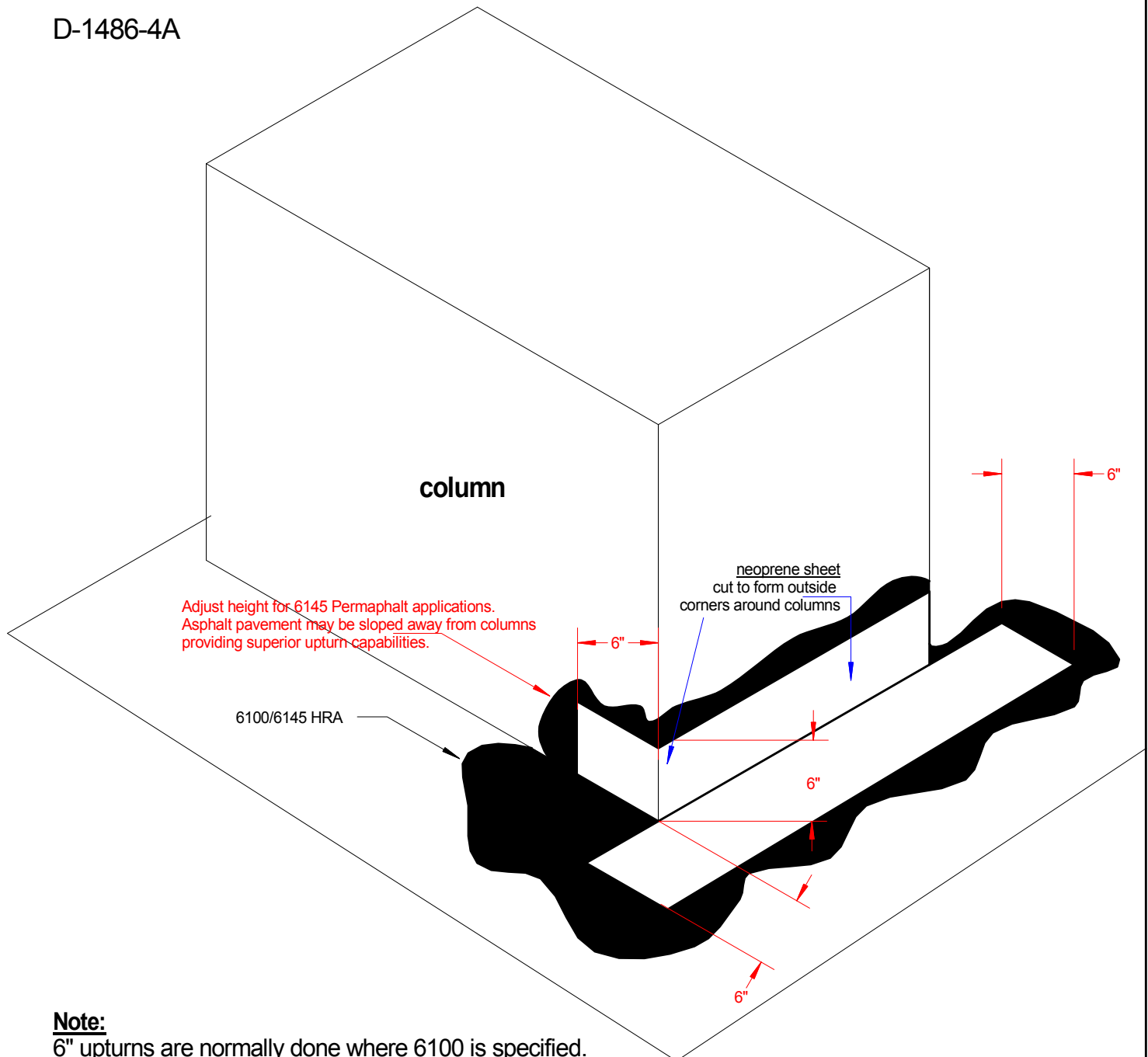

**Note:**

6" upturns are normally done where 6100 is specified.  
Upturns may be adjusted for 6145 Permaphalt applications.

Tremco Canada  
6178 Netherhart Rd.  
Mississauga, On.  
L5T 1B7  
Ph: 905-564-6100  
Fax: 905-564-6110

**Tremco Inc.**  
www.tremcosealants.com

Tremco Inc.  
3735 Green Rd,  
Beachwood, OH. USA  
44122  
Ph: 216-292-5000  
Fax: 216-292-5036

Date: Jun-25-2009		Drawing No. D-1486-4A
Drawn by: G.M.	Approved: <>	Scale:
Project:		typical



6100 / 6145 HRA membrane systems.

Shown: Tie-in to Tremco's urethane membrane system.

D-1162-1A-R1

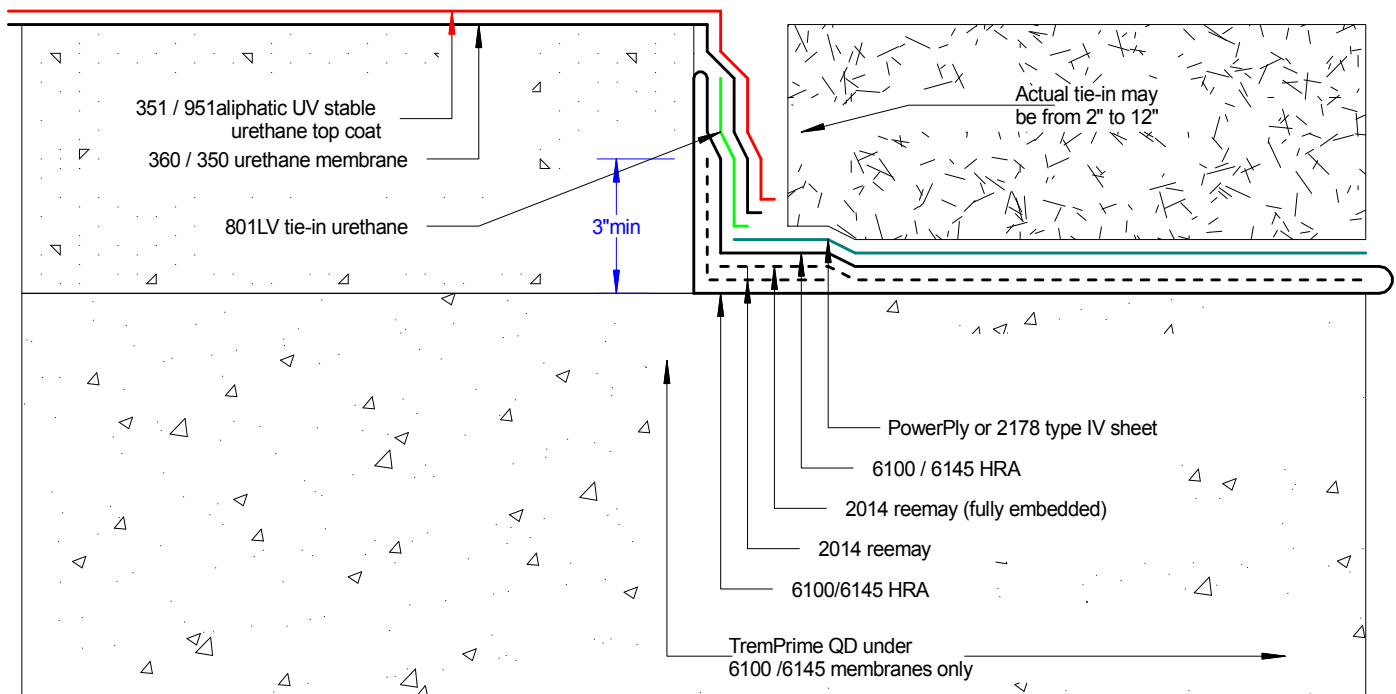

Tremco Canada  
6178 Netherhart Rd.  
Mississauga, On.  
L5T 1B7  
Ph: 905-564-6100  
Fax: 905-564-6110

**Tremco Inc.**  
www.tremcosealants.com

Tremco Inc.  
3735 Green Rd,  
Cleveland, OH. USA  
44122  
Ph: 216-292-5000  
Fax: 216-292-5036

<u>Date:</u> Apr-8-2009		<u>Drawing No.</u> D-1162-1A-R1
<u>Drawn by:</u> G.M.	<u>Approved:</u> <>	<u>Scale:</u>
<u>Project:</u>		