

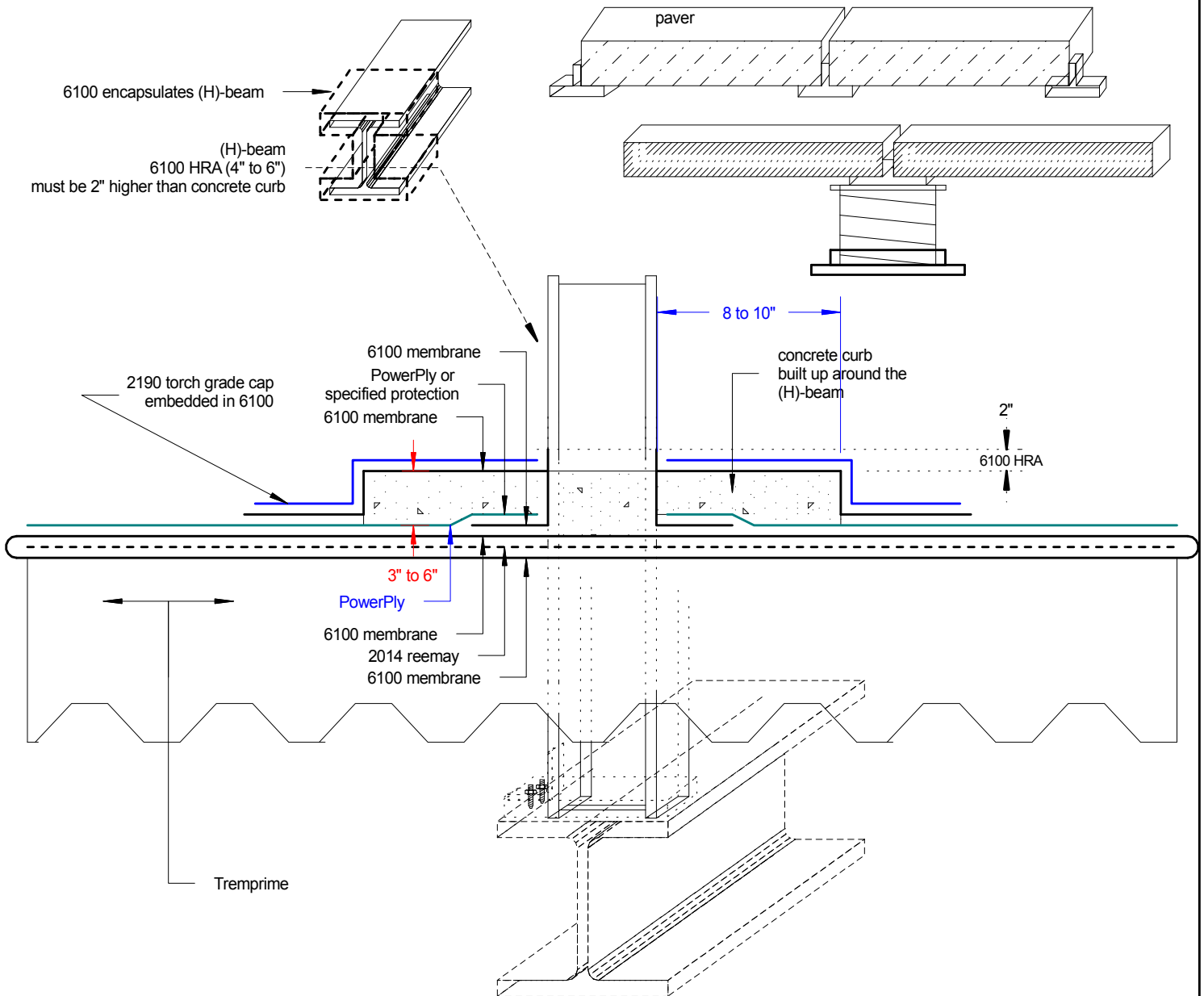

## 6100 HRA Installation to (H)-beam detail> D-876-1



Tremco Canada  
6178 Netherhart Rd.  
Mississauga, On.  
L5T 1B7  
Ph: 905-564-6100  
Fax: 905-564-6110

**Tremco Inc.**  
[www.tremcosealants.com](http://www.tremcosealants.com)

Tremco Inc.  
3735 Green Rd,  
Cleveland, OH. USA  
44122  
Ph: 216-292-5000  
Fax: 216-292-5036

Date: Apr-29-2008

Drawing No.  
D-876-1

Drawn by:  
G.M.

Approved:  
<>

Scale:

Project: typical



## 6100 HRA Installation to (H)-beam c/w topping slab

detail> D-877-1A

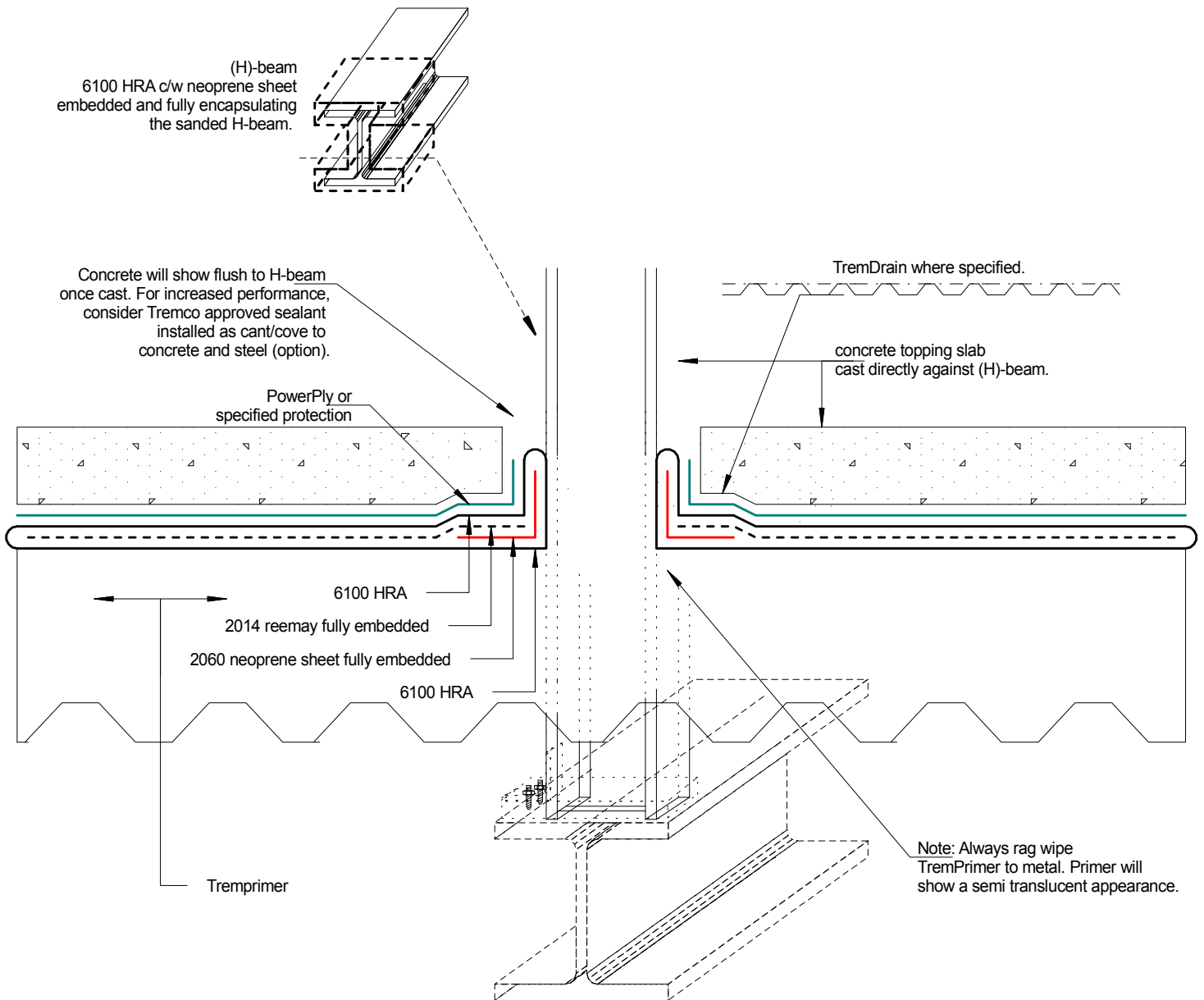

Tremco Canada  
6178 Netherhart Rd.  
Mississauga, On.  
L5T 1B7  
Ph: 905-564-6100  
Fax: 905-564-6110

**Tremco Inc.**  
www.tremcosealants.com

Tremco Inc.  
3735 Green Rd,  
Cleveland, OH. USA  
44122  
Ph: 216-292-5000  
Fax: 216-292-5036

Date: Apr-8-2010		Drawing No. D-877-1A
Drawn by: G.M.	Approved: <>	Scale:
Project:		typical



## 6100 HRA Installation to (H)-beam c/w topping slab

detail> D-877-2A

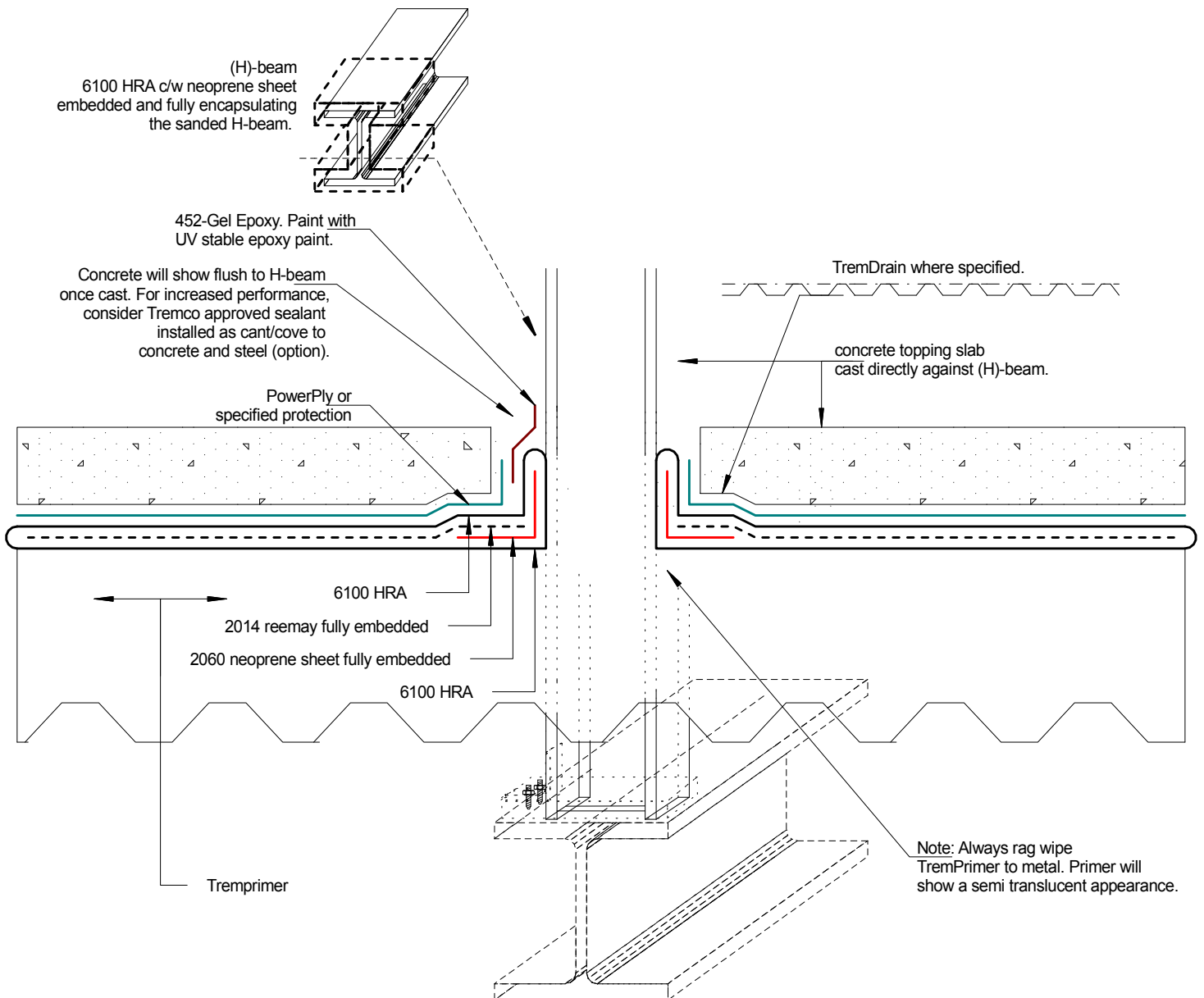

Tremco Canada  
6178 Netherhart Rd.  
Mississauga, On.  
L5T 1B7  
Ph: 905-564-6100  
Fax: 905-564-6110

**Tremco Inc.**  
[www.tremcosealants.com](http://www.tremcosealants.com)

Tremco Inc.  
3735 Green Rd,  
Cleveland, OH. USA  
44122  
Ph: 216-292-5000  
Fax: 216-292-5036

Date: Jun-4-2012		Drawing No. D-877-2A
Drawn by: G.M.	Approved: <>	Scale:
Project:		typical