

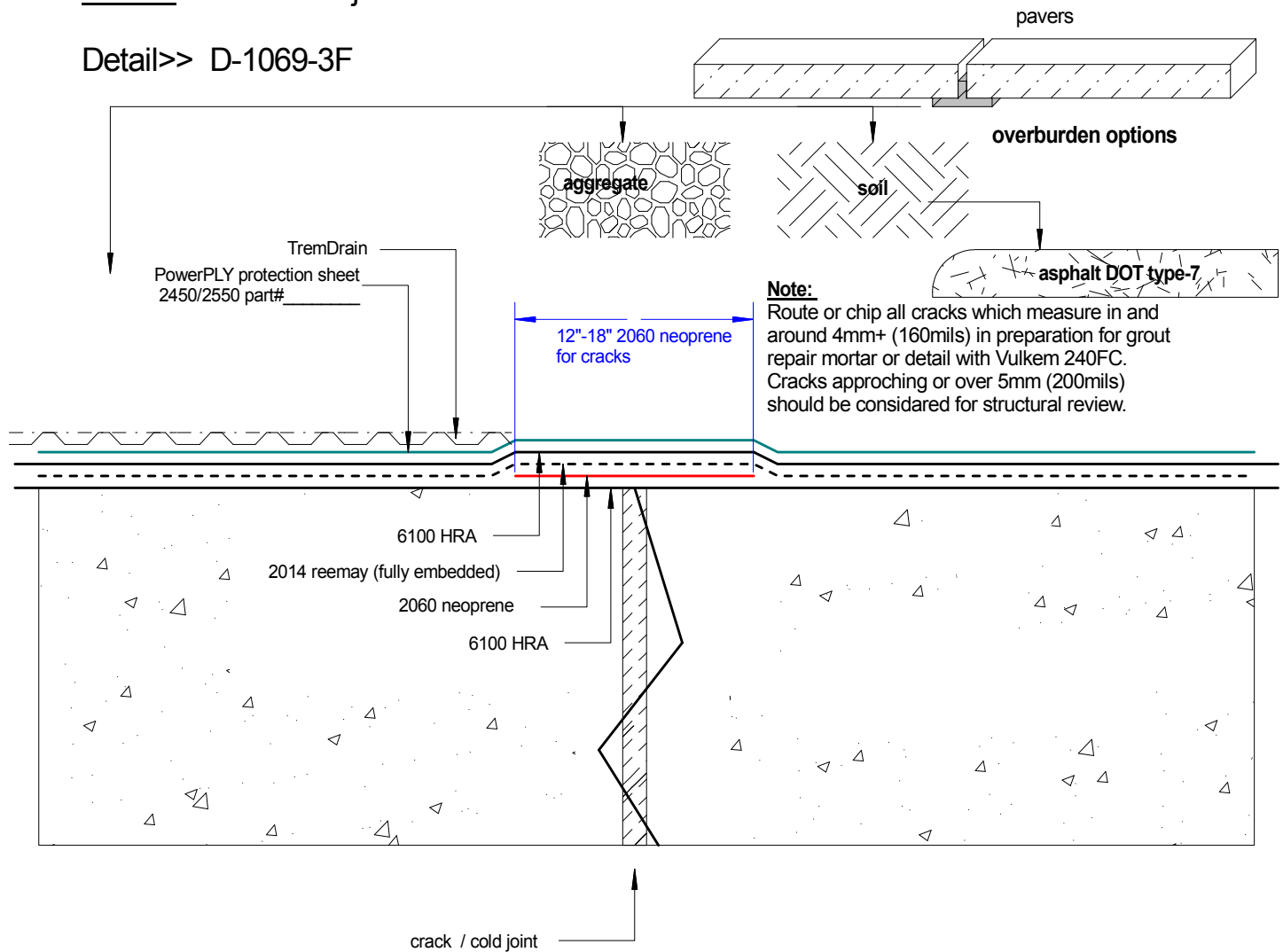

TP-6100 Membrane Crack / Cold joint Detail

shown: crack / cold joint reinforcement to concrete substrate.

Detail>> D-1069-3F



Tremco Canada
6178 Netherhart Rd.
Mississauga, On.
L5T 1B7
Ph: 905-564-6100
Fax: 905-564-6110

Tremco Inc.
www.tremcosealants.com

Tremco Inc.
3735 Green Rd,
Cleveland, OH. USA
44122
Ph: 216-292-5000
Fax: 216-292-5036

Date: July-22-2008		Drawing No. D-1069-3F
Drawn by: G.M.	Approved: <>	Scale:
Project:		



TP-6100 HRA membrane
typical crack reinforcement detail.

D-468-1B

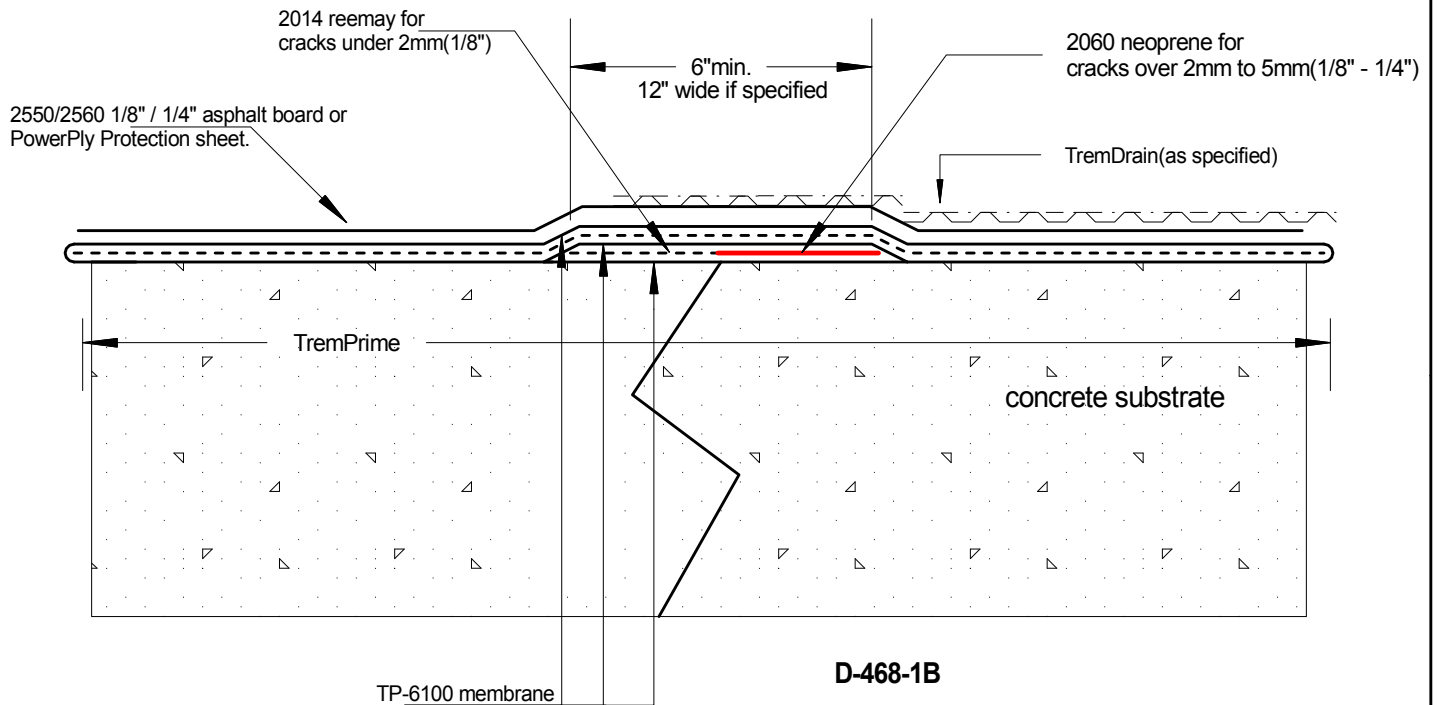

Tremco Canada
6178 Netherhart Rd.
Mississauga, On.
L5T 1B7
Ph: 905-564-6100
Fax: 905-564-6110

Tremco Inc.
www.tremcosealants.com

Tremco Inc.
3735 Green Rd,
Cleveland, OH. USA
44122
Ph:216-292-5000
Fax: 216-292-5036

<u>Date:</u> Jan-12-2008		<u>Drawing No.</u> D-468-1B
<u>Drawn by:</u> G.M.	<u>Approved:</u> <>	<u>Scale:</u>
<u>Project:</u> Typical		