

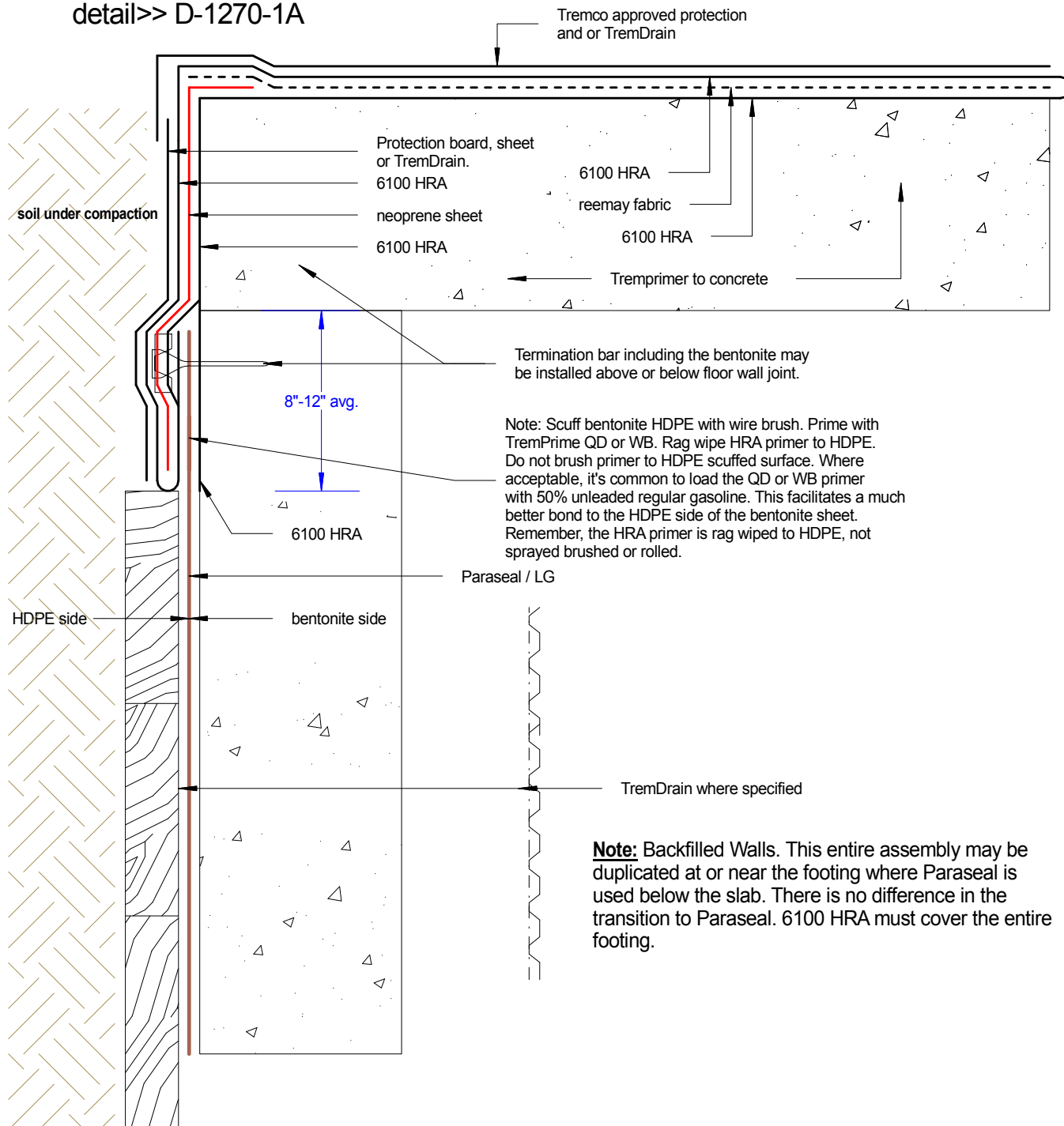

## 6100 HRA transition to Paraseal Bentonite sheet

Shown: Paraseal sandwiched between 6100 HRA layers.

detail>> D-1270-1A



Tremco Canada  
6178 Netherhart Rd.  
Mississauga, On.  
L5T 1B7  
Ph: 905-564-6100  
Fax: 905-564-6110

**Tremco Inc.**  
www.tremcosealants.com

Tremco Inc.  
3735 Green Rd,  
Beachwood, OH. USA  
44122  
Ph: 216-292-5000  
Fax: 216-292-5036

Date: Sep-19-2009		Drawing No. D-1270-1A
Drawn by: G.M.	Approved: <>	Scale:
Project:		



## Horizontal waterproofing transition to vertical Paraseal bentonite installation. Shown: Exposed downturn transition

Detail>> D-1288-6A

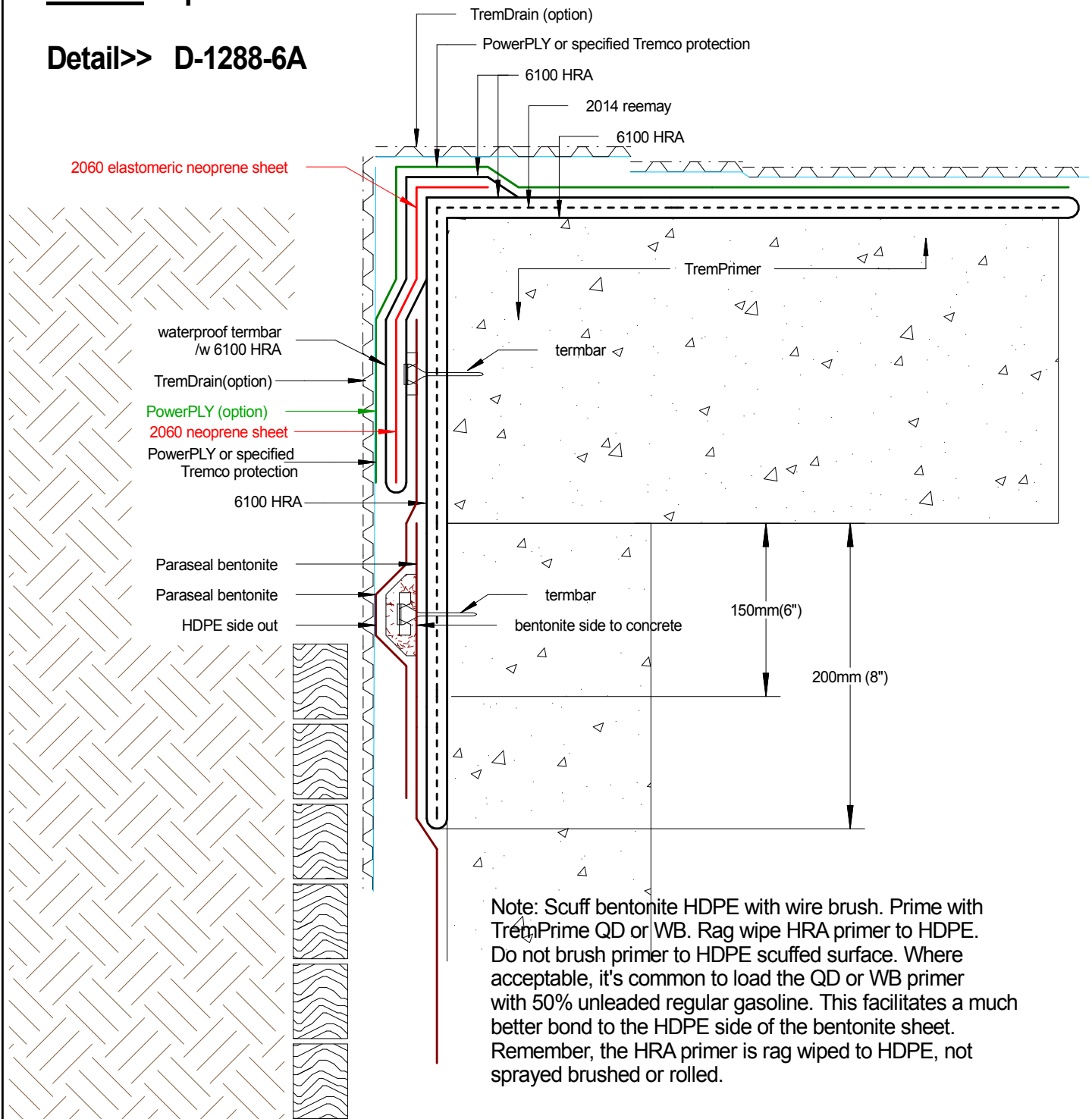

Note: Scuff bentonite HDPE with wire brush. Prime with TremPrime QD or WB. Rag wipe HRA primer to HDPE. Do not brush primer to HDPE scuffed surface. Where acceptable, it's common to load the QD or WB primer with 50% unleaded regular gasoline. This facilitates a much better bond to the HDPE side of the bentonite sheet. Remember, the HRA primer is rag wiped to HDPE, not sprayed brushed or rolled.

Tremco Canada  
6178 Netherhart Rd.  
Mississauga, On.  
L5T 1B7  
Ph: 905-564-6100  
Fax: 905-564-6110

**Tremco Inc.**  
www.tremcosealants.com

Tremco Inc.  
3735 Green Rd,  
Cleveland, OH. USA  
44122  
Ph: 216-292-5000  
Fax: 216-292-5036

Date: Feb-28-2009		Drawing No. D-1288-6A
Drawn by: G.M.	Approved: <>	Scale:
Project:		