

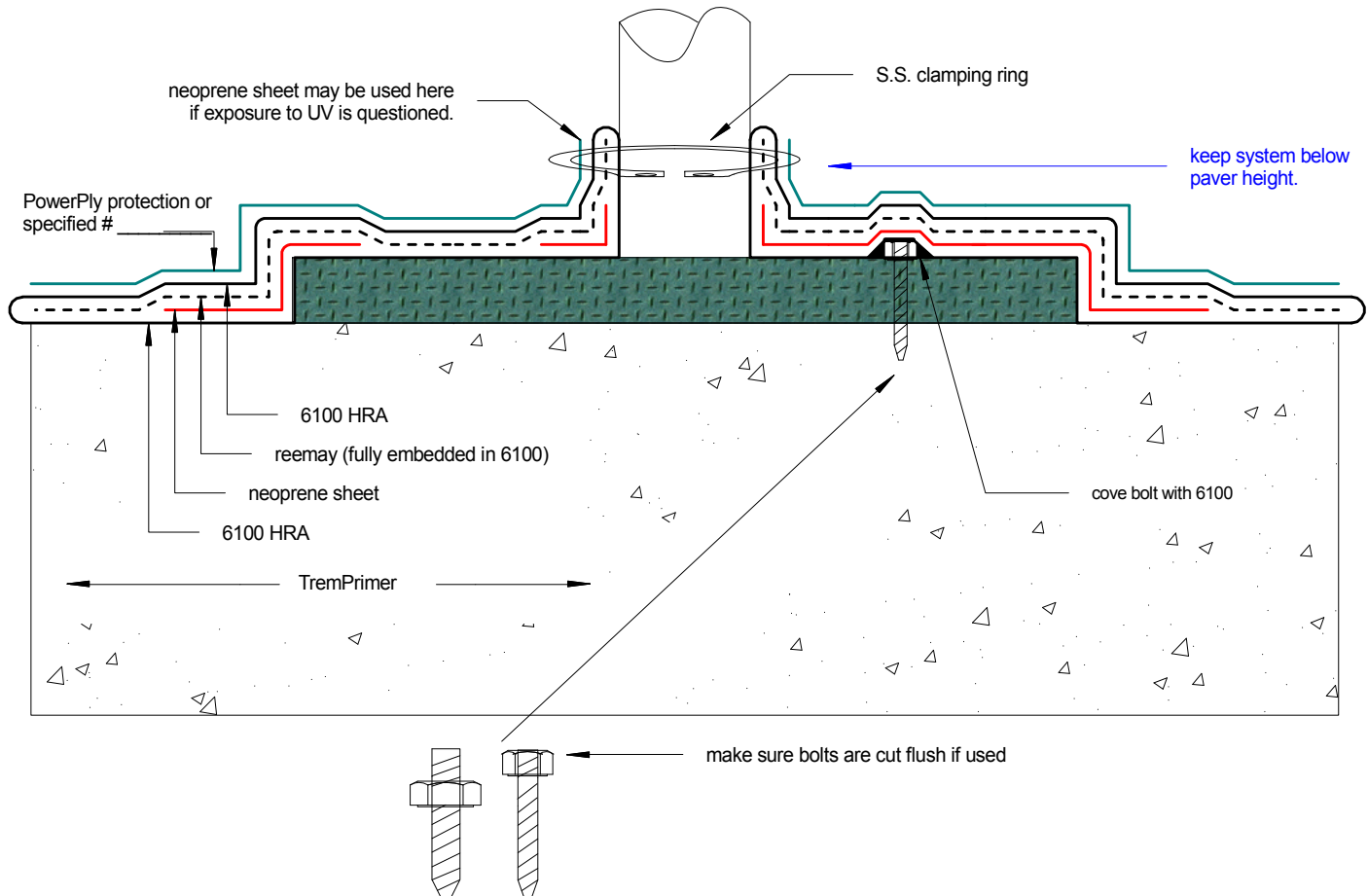

6100 HRA System to Metal Support Plate

Shown: 6100 fully reinforced over bolted and non-bolted welded steel plate.

Detail: D-1415-12A



Tremco Canada
6178 Netherhart Rd.
Mississauga, On.
L5T 1B7
Ph: 905-564-6100
Fax: 905-564-6110

Tremco Inc.
www.tremcosealants.com

Tremco Inc.
3735 Green Rd,
Beachwood, OH. USA
44122
Ph: 216-292-5000
Fax: 216-292-5036

| | | |
|----------------------|-----------------|---------------------------|
| Date: Jul-30-2009 | | Drawing No. D-1415-12A |
| Drawn by: G.M. | Approved: <> | Scale: |
| Project: | | typical |



6100 HRA detail to underside of
bolted/doweled metal support plate.

detail>> D-966-3A

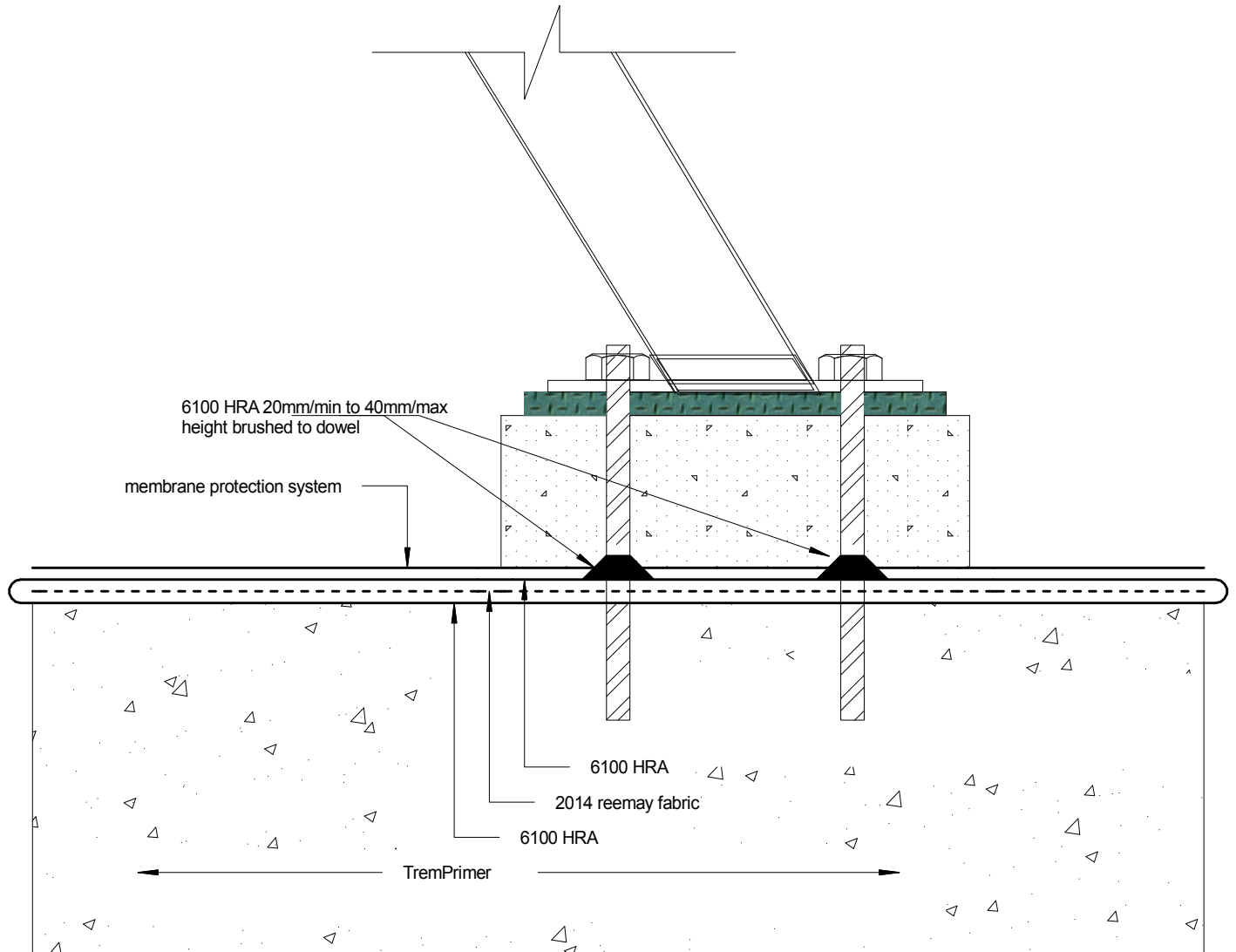

Tremco Canada
6178 Netherhart Rd.
Mississauga, On.
L5T 1B7
Ph: 905-564-6100
Fax: 905-564-6110

Tremco Inc.
www.tremcosealants.com

Tremco Inc.
3735 Green Rd,
Cleveland, OH. USA
44122
Ph: 216-292-5000
Fax: 216-292-5036

| | | |
|--------------------------|------------------------|--------------------------------|
| <u>Date:</u> Dec-16-2008 | | <u>Drawing No.</u> D-966-3A |
| <u>Drawn by:</u> G.M. | <u>Approved:</u> <> | <u>Scale:</u> |
| <u>Project:</u> | | |



Metal Support Plate detail

6100 HRA membrane system
draft>> D-497-1A

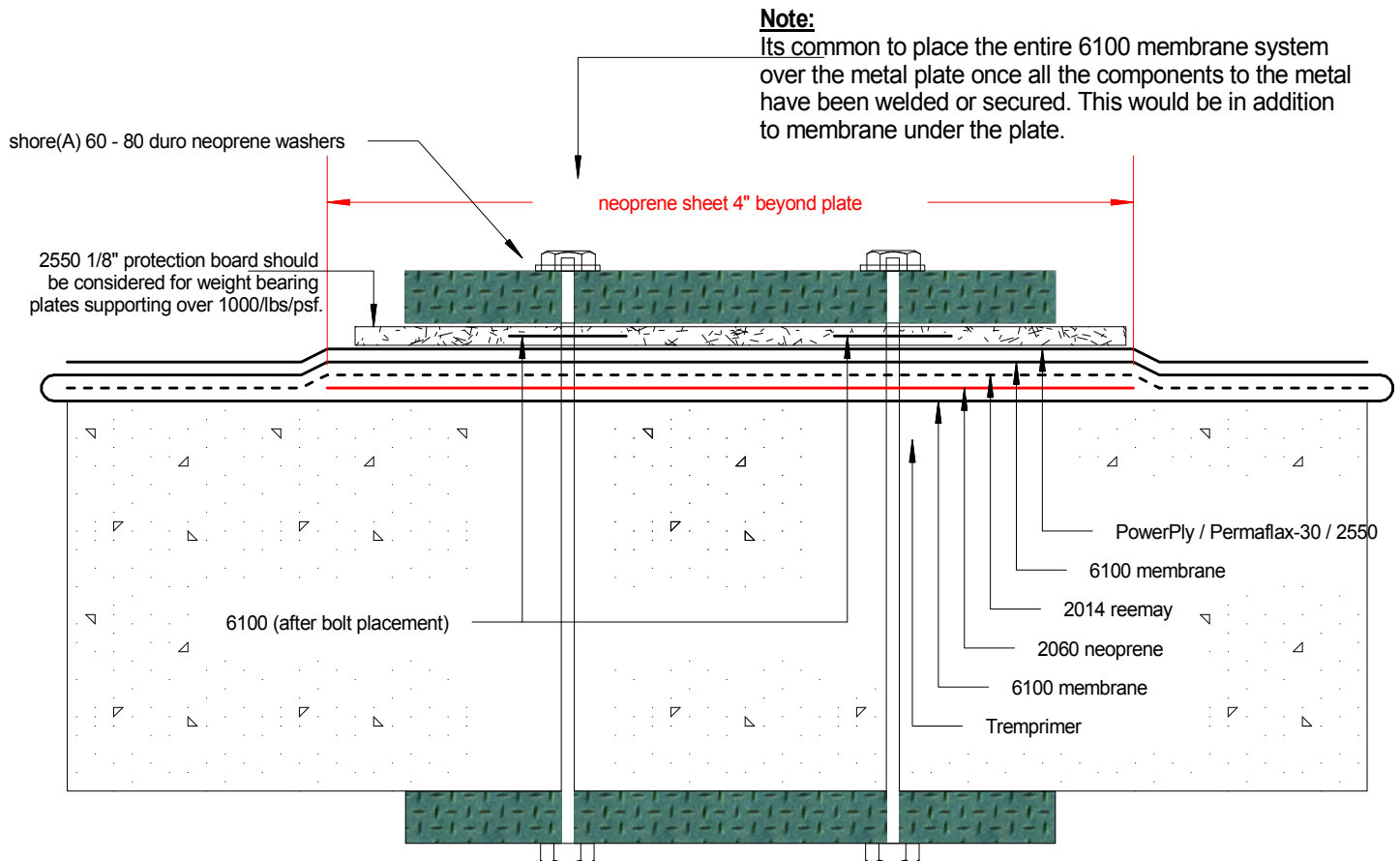

Note:

make sure 6100 is applied to bolt.

Tremco Canada
6178 Netherhart Rd.
Mississauga, On.
L5T 1B7
Ph: 905-564-6100
Fax: 905-564-6110

Tremco Inc.
www.tremcosealants.com

Tremco Inc.
3735 Green Rd,
Cleveland, OH. USA
44122
Ph: 216-292-5000
Fax: 216-292-5036

Date:
Nov-17-2007

Drawing No.
D-497-1B

Drawn by: G.M.
Approved: <>

Scale:

Project: typical



6100 HRA Bolted Plate Reinforcement

Shown: reinforced HRA top of bolted plate.

detail>> D-1288-181A

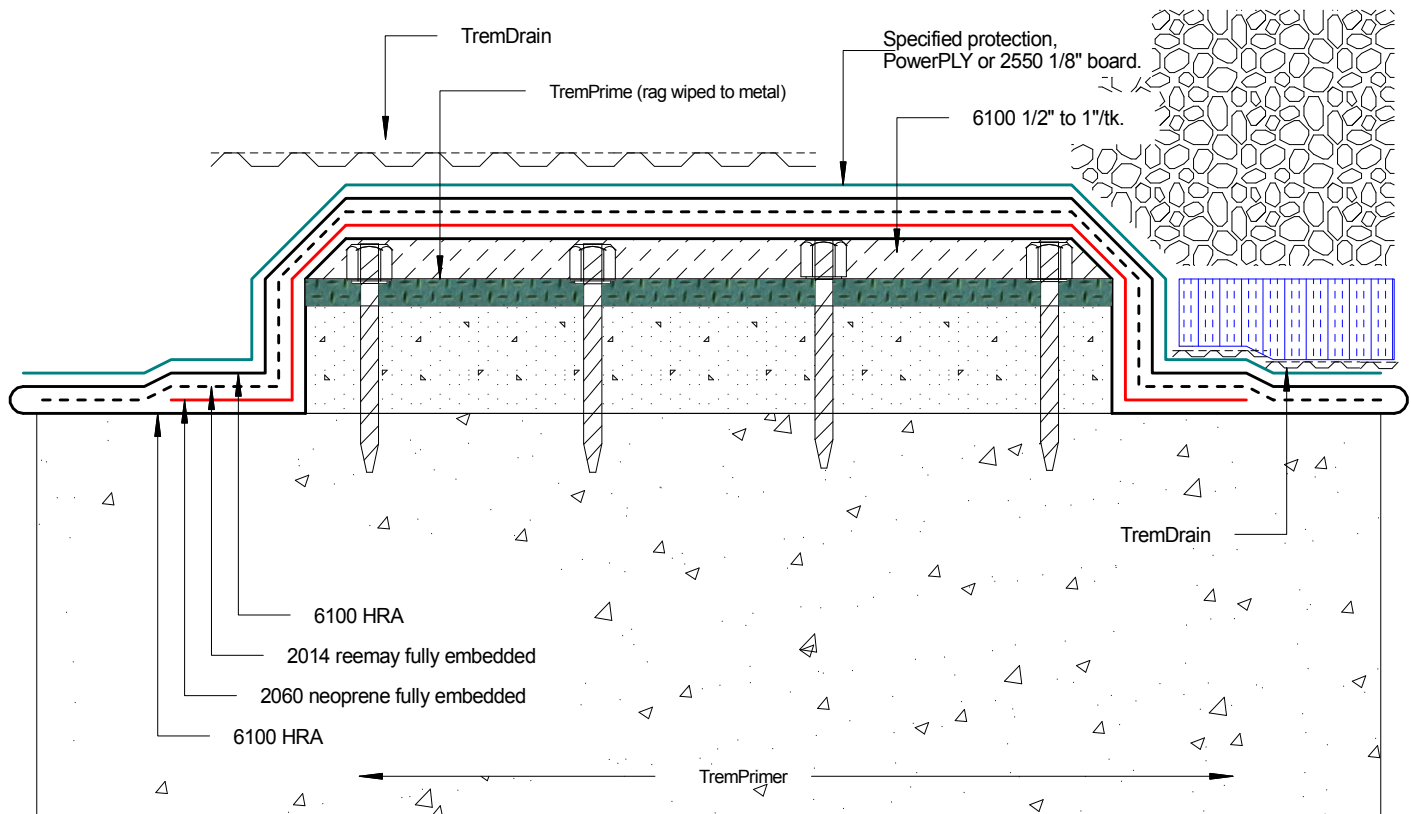

Tremco Canada
6178 Netherhart Rd.
Mississauga, On.
L5T 1B7
Ph: 905-564-6100
Fax: 905-564-6110

Tremco Inc.
www.tremcosealants.com

Tremco Inc.
3735 Green Rd,
Beachwood, OH. USA
44122
Ph: 216-292-5000
Fax: 216-292-5036

| | | |
|----------------------|-----------------|----------------------------|
| Date: Apr-26-2010 | | Drawing No. D-1288-181A |
| Drawn by: G.M. | Approved: <> | Scale: |
| Project: | | |



6100 HRA Bolted Plate Reinforcement

Shown: reinforced HRA top of grouted bolted plate.

detail>> D-1288-183A

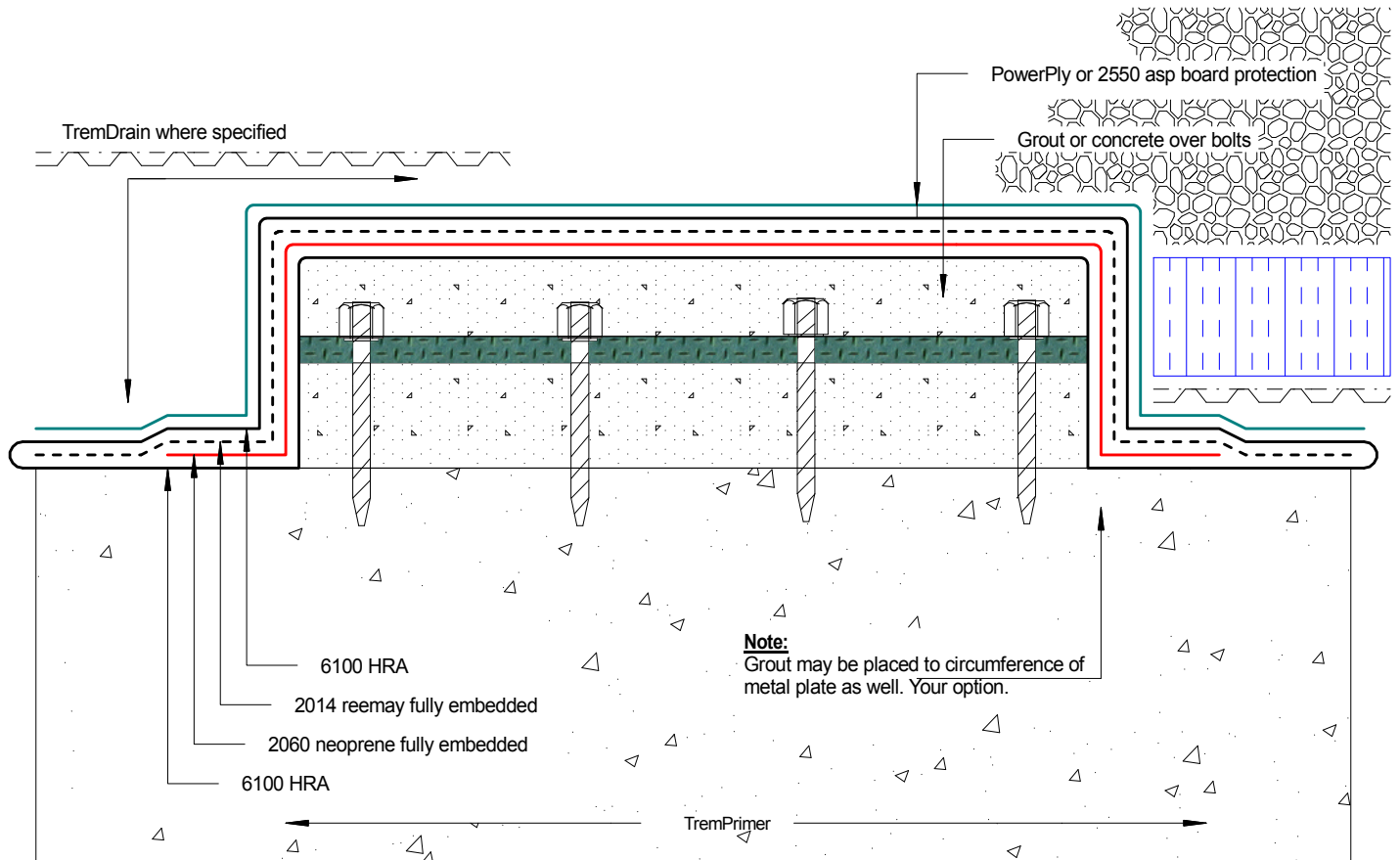

Tremco Canada
6178 Netherhart Rd.
Mississauga, On.
L5T 1B7
Ph: 905-564-6100
Fax: 905-564-6110

Tremco Inc.
www.tremcosealants.com

Tremco Inc.
3735 Green Rd,
Beachwood, OH. USA
44122
Ph: 216-292-5000
Fax: 216-292-5036

| | | |
|---------------------|-----------------|----------------------------|
| Date: May-5-2010 | | Drawing No. D-1288-183A |
| Drawn by: G.M. | Approved: <> | Scale: |
| Project: | | |

| | |
|-----------------|---------|
| <u>Project:</u> | Typical |
|-----------------|---------|